

PARTS LIST

Setting-up and Operating Instructions for

Taylor-Way
REG. U. S. PAT. OFF.

PULVERIZING WING TYPE TANDEM HARROW

18", 20" OR 22" DISCS

Model Number	Size of Wings	No. of Discs	Disc Spacing	Width of Cut	8" DISC SPACING			Suggested D.B.H.P.
					1 1/2" SQUARE AXLE			
					Approximate Weight			
					18" C.O.	20" C.O.	22" C.O.	
200208	Basic Unit, Less Wings	28	8"	10'3"	2635	2700	2825	50
200209	With Four Disc Wings	44	8"	15'3"	3575	3720	3875	70
200210	With Five Disc Wings	48	8"	16'3"	3695	3860	4030	80
200212	Basic Unit, Less Wings	40	8"	14'0"	3340	3530	3620	70
200213	With Four Disc Wings	56	8"	19'1"	4280	4550	4670	90
200214	With Five Disc Wings	60	8"	20'4"	4400	4690	4825	100

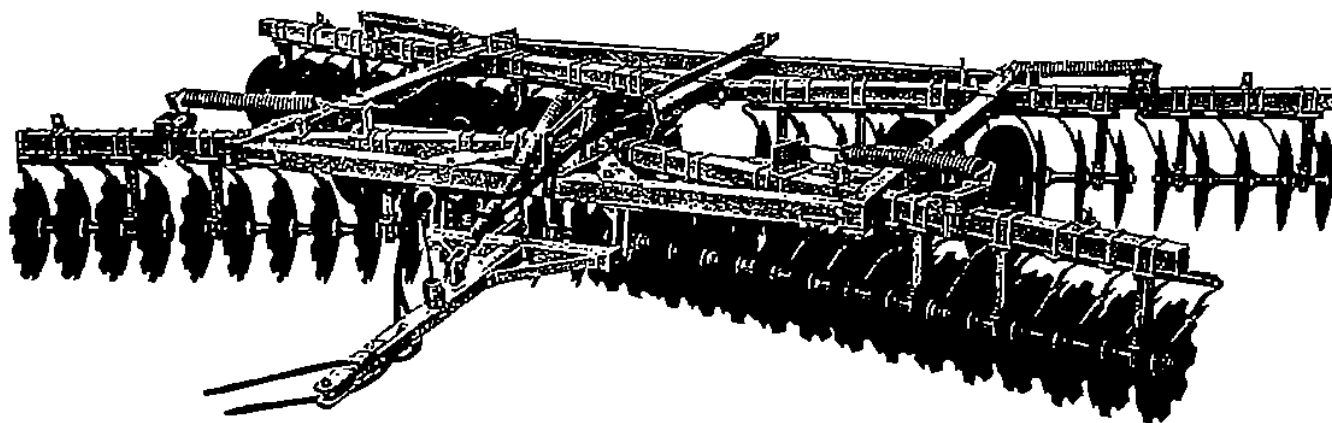

MODEL 200214
With Five Disc Wings

Taylor Implement Manufacturing Company
MANUFACTURERS
TRACTOR DRAWN **Taylor-Way** IMPLEMENTS
REG. U. S. PAT. OFF.

ATHENS, TENNESSEE 37303—TELEPHONE (AREA CODE 615) 745-3110

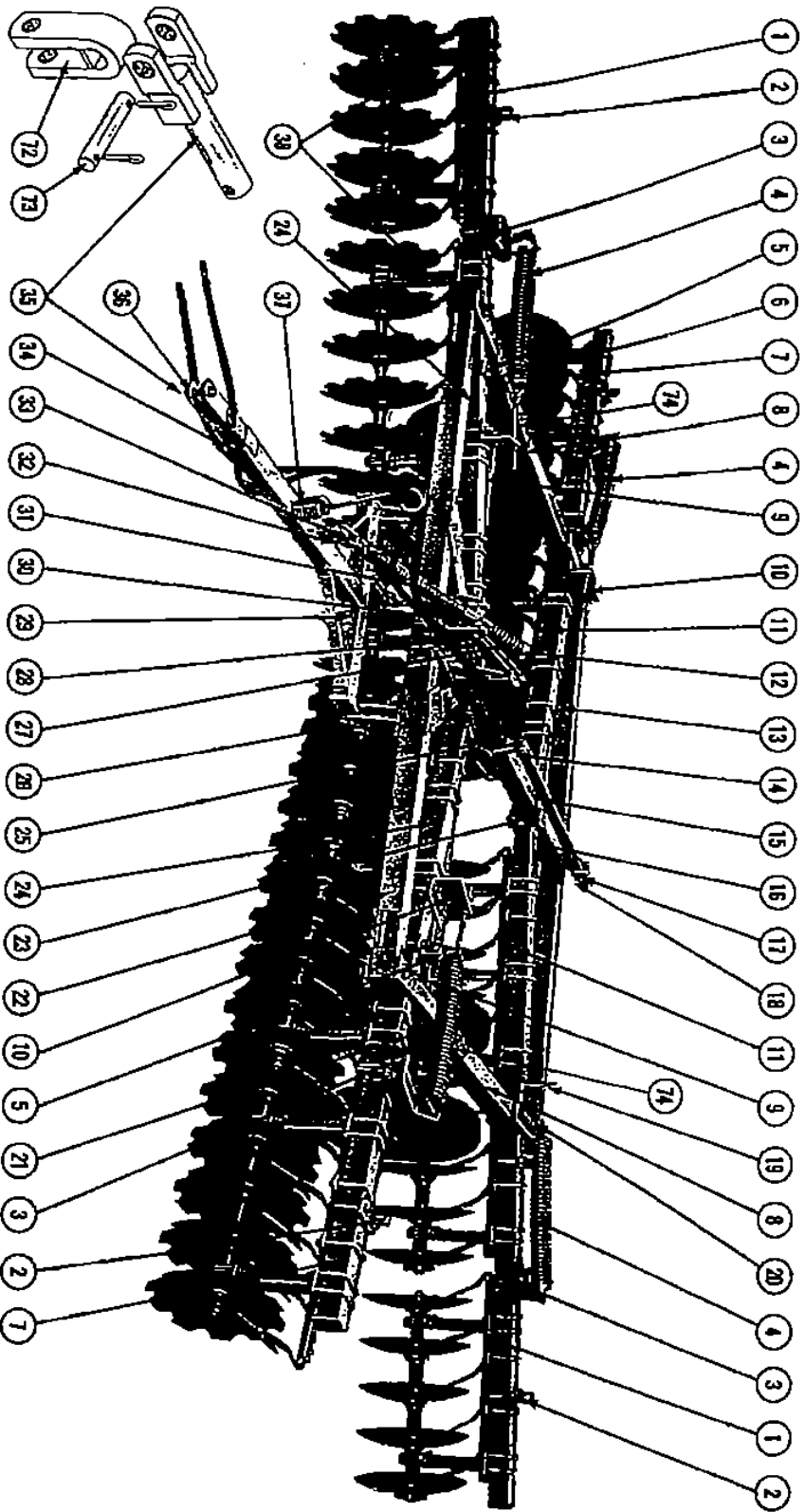

PLATE 1 — MODEL 200214—PULVERIZING WING-TYPE TANDEM HARROW

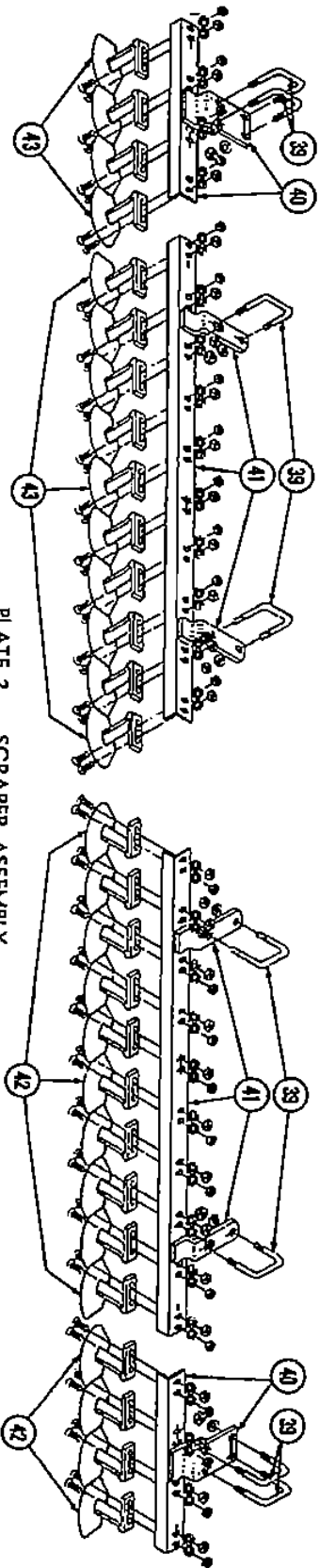

PLATE 2 — SCRAPER ASSEMBLY

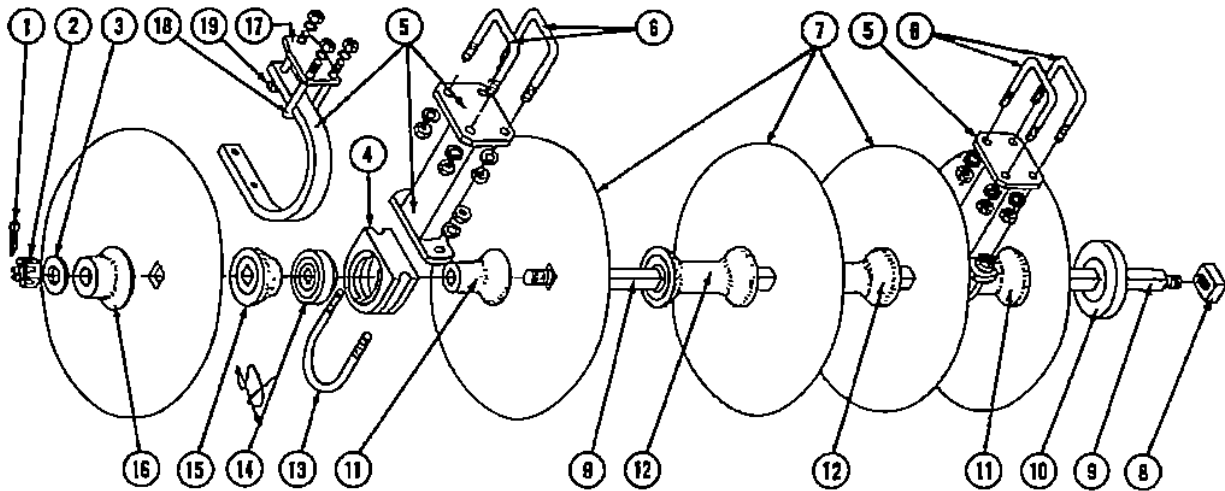

PLATE 8 — DISC GANG ASSEMBLY

Item No.	Part Number	FOR MODEL						Description	Size	Item No.	Part Number	FOR MODEL						Description	Size
		200	200	200	200	200	200					208	209	210	212	213	214		
1.		4	8	8	4	8	8	Cotter	3/16"x2"	9.	207098	4	4	4	0	0	0	7-Disc Axle, 8" Spacing, 53"	
2.		4	8	8	4	8	8	Hex Slotted Nut	1 1/8"		202439	0	0	0	4	4	6-Disc Axle, 8" Spacing, 45"		
3.		4	8	8	4	8	8	Flat Washer	1 1/8"		207637	0	0	4	0	0	5-Disc Axle, 8" Spacing, 37"		
4.	205722	12	20	20	16	24	24	Bearing Holder			207638	0	4	0	4	8	4	4-Disc Axle, 8" Spacing, 29"	
5.	207585	12	20	20	16	24	24	Bearing Connector		10.	206613	4	8	8	4	8	8	Butt-Plate	
	207664	12	20	20	16	24	24	Spring Bearing Connector		11.	207342	12	20	20	15	24	24	Long Convex Spacer	
6.	603013	24	40	40	32	48	48	U-Bolt w/Nut	5/8"	12.	207339	12	15	20	16	20	24	Long Double End Spacer	
		48	80	80	64	96	96	Lock Washer	5/8"	13.	205828	12	20	20	16	24	24	U-Bolt w/Nuts	3/8"
7.	205003	28	44	48	40	56	60	18" Round Disc				24	40	40	32	48	48	Lock Washer	5/8"
	205002	28	44	48	40	56	60	18" Cut-Out Disc		14.	204147	12	20	20	16	24	24	Ball Bearing	
	204004	28	44	48	40	56	60	20" Round Disc		15.	207341	12	20	20	16	24	24	Concave Spacer	
	204003	28	44	48	40	56	60	20" Cut-Out Disc		16.	204704	4	8	8	8	12	12	End Washer	
	204010	28	44	48	40	56	60	22" Round Disc		17.	207810	12	20	20	16	24	24	Strap	
	205020	28	44	48	40	56	60	22" Heavy-Duty Round Disc		18.	207808	12	20	20	16	24	24	U-Bolt w/Nuts	
	204005	28	44	48	40	56	60	22" Cut-Out Disc				24	40	40	32	48	48	Lock Washer	3/4"
	205005	28	44	48	40	56	60	22" Heavy-Duty Cut-Out Disc		19.		12	20	20	16	24	24	Bolt w/Nut	1/4"x5/8"
8.		4	8	8	4	8	8	Square Nut	1 1/8"			12	20	20	16	24	24	Lock Washer	3/4"

Item No.	Part Number	FOR MODEL						Description	Size
		200	200	200	200	200	200		
1.	205993	4	4	4	4	4	4	14" Wheel For Rubbar	
	205992	4	4	4	4	4	4	15" Wheel For Rubbar	
2.	403817	24	24	24	24	24	24	Lug Bolt	
3.	204515	4	4	4	4	4	4	Wheel Hub w/2 Cups	
4.	204523	4	4	4	4	4	4	Hub Cap	
5.	204522	4	4	4	4	4	4	Bearing Adjust. Nut	
		4	4	4	4	4	4	Cotter	5/32"x1 1/4"
6.	204521	4	4	4	4	4	4	Special Flat Washer	
7.	204524	4	4	4	4	4	4	Bearing Cone	
8.	203021	4	4	4	4	4	4	Bearing Cup	
9.	204526	4	4	4	4	4	4	Bearing Cone	
10.	204525	4	4	4	4	4	4	Bearing Cup	
11.	204527	4	4	4	4	4	4	Grease Seal	
12.	206443	2	2	2	2	2	2	Double Hub Axle	
13.	204520	4	4	4	4	4	4	Dust Collar	

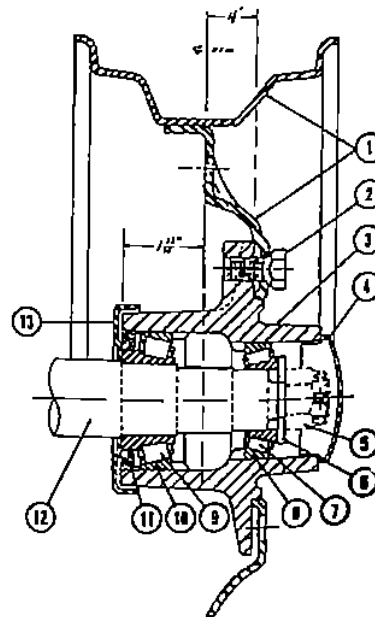

PLATE 9 — WHEEL HUB ASSEMBLY

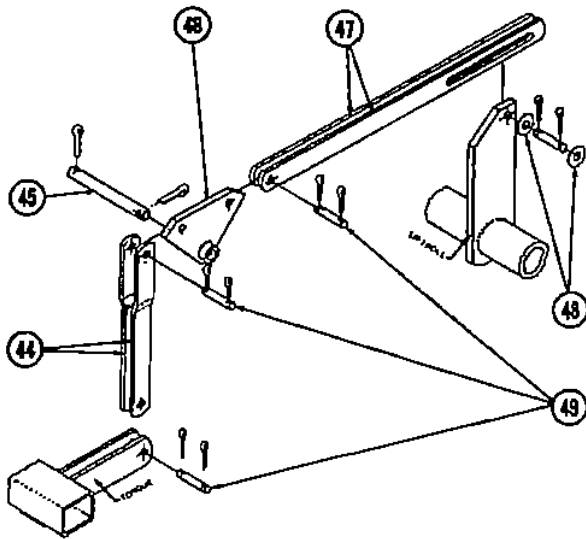

PLATE 3 — LEVELING ASSEMBLY

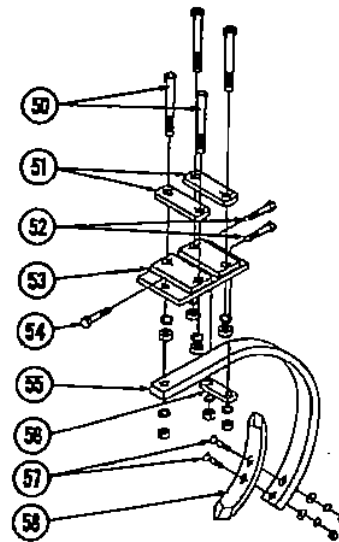

PLATE 4 — BALK BREAKER ATTACHMENT — MACH. NO. 299053

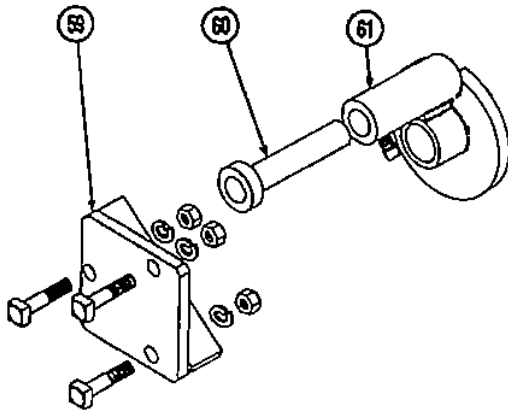

PLATE 5 — GANG COUPLER MACH. NO. 200092

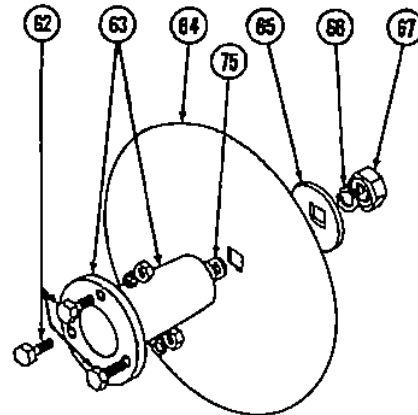

PLATE 6 — FURROW FILLER ATTACHMENT — MACH. NO. 200080

Item No.	Part Number	FOR MODEL						Description	Size
		200	201	202	203	204	205		
58.	603014	1	1	1	1	1	1	Chisel	
59.	207315	0	4	4	4	8	8	Butt Plate Drive	
		0	12	12	12	24	24	Bolt w/Nut	1/2" x 2 1/4"
		0	12	12	12	24	24	Lock Washer	1/2"
60.	207312	0	4	4	4	8	8	Adjustable Reach Rod	
61.	207307	0	4	4	4	8	8	End Washer Drive	
62.		6	6	6	6	6	6	Bolt w/Nut	1/2" x 1 1/2"
		6	6	6	6	6	6	Lock Washer	1/2"
63.	206629	2	2	2	2	2	2	Furrow Filler Spacer	
64.	204000	2	2	2	2	2	2	16" Round Disc	
	204001	2	2	2	2	2	2	18" Round Disc	
65.	203986	2	2	2	2	2	2	Fur. Fil. Butt Plate	
66.		2	2	2	2	2	2	Lock Washer	
67.		2	2	2	2	2	2	Hex Nut	7/8"
68.	207200	0	4	4	0	4	4	Washer	7/8"
69.	207358	0	4	4	0	4	4	Keeper	
70.	403177	0	4	4	0	4	4	Spring	
71.		0	4	4	0	4	4	Cotter	
72.	205258	1	1	1	1	1	1	Clevis	5/32" x 1 1/4"
73.	207860	1	1	1	1	1	1	Pin	
		2	2	2	2	2	2	Cotter	
74.	207861	3	3	3	3	3	3	Plate	3/8" x 2"
75.		2	2	2	2	2	2	Bolt	1/8" x 2 1/4"

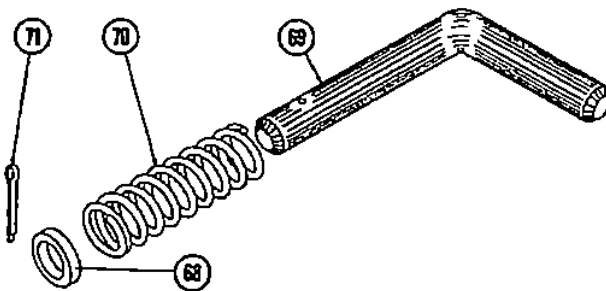

PLATE 7 — INTERNAL PARTS FOR WING SAFETY LATCH

SETTING-UP INSTRUCTIONS

Pulverizing Wing-Type Tandem Harrow

General

Right and Left are determined by standing at the rear of the harrow. All items designated as Right and Left fit into their respective positions on the front section. When used on the rear section, the procedure is reversed and items designated as Right will fit on the left side and vice versa.

These harrows are shipped "knocked down" and Models 200208 and 200212 will consist of thirteen bundles. Models 200209, 200210, 200213 and 200214 will consist of nineteen bundles as shown on the following bundle list.

Bundle Number	BUNDLES REQUIRED						Description
	200	200	209	200	200	210	
201100	1	1	1	1	1	1	Tongue Bundle
201101	1	1	1	0	0	0	Front and Rear Cross Frames
201128	0	0	0	1	1	1	Front and Rear Cross Frames
201102	1	1	1	0	0	0	Center Frame Bundle
201129	0	0	0	1	1	1	Center Frame Bundle
201103	1	1	1	0	0	0	Side Frames
201130	0	0	0	1	1	1	Side Frames
201104	1	1	1	0	0	0	Wheel Axle Bundle w/Hubs
201131	0	0	0	1	1	1	Wheel Axle Bundle w/Hubs
200595	4	4	4	4	4	4	14" Rims*
200596	4	4	4	4	4	4	15" Rims*
201105	1	1	1	0	0	0	Right Front 7-Disc Gang
201106	1	1	1	0	0	0	Left Front 7-Disc Gang
201107	1	1	1	0	0	0	Right Rear 7-Disc Gang
201108	1	1	1	0	0	0	Left Rear 7-Disc Gang
201109	0	0	0	1	1	1	Right Front 10-Disc Gang
201110	0	0	0	1	1	1	Left Front 10-Disc Gang
201111	0	0	0	1	1	1	Right Rear 10-Disc Gang
201112	0	0	0	1	1	1	Left Rear 10-Disc Gang
201113	0	1	0	0	1	0	Right Front 4-Disc Wing Gang
201114	0	1	0	0	1	0	Left Front 4-Disc Wing Gang
201115	0	1	0	0	1	0	Right Rear 4-Disc Wing Gang
201116	0	1	0	0	1	0	Left Rear 4-Disc Wing Gang
201117	0	0	1	0	0	1	Right Front 5-Disc Wing Gang
201118	0	0	1	0	0	1	Left Front 5-Disc Wing Gang
201119	0	0	1	0	0	1	Right Rear 5-Disc Wing Gang
201120	0	0	1	0	0	1	Left Rear 5-Disc Wing Gang
201121	0	1	1	0	1	1	Wing Spring Bundle
201122	0	1	1	0	1	1	Wing Spring Holder Bundle

* Denotes Optional Rims.

If implements are ordered with Extra Equipment these bundles will be shipped as shown below.

Extra Equipment

- Machinery No. 200080—Furrow Filler Attachment, less Discs.
 Furrow Filler Attachment w/16" Rd. Discs.
 Furrow Filler Attachment w/18" Rd. Discs.
 All with or without scrapers.
- Machinery No. 200092—Gang Coupler (when shipped assembled—
 with implement included in gang bundles.)
- Machinery No. 299063—Balk Breaker Attachment.

Bundle Number	BUNDLES REQUIRED			Description
	200	200	299	
201048	1	0	0	Furrow Filler Attachment, Less Disc
201049	1	0	0	Furrow Filler Attachment, w/16" Rd. Disc.
201050	1	0	0	Furrow Filler Attachment, w/18" Rd. Disc.
201123	1	0	0	Scrapers For Furrow Filler, Optional
201051	0	1	0	Gang Coupler
201127	0	0	1	Balk Breaker Attachment

Basic Harrow Assembly

Remove all bundling wire and proceed as follows:

1. Remove the U-bolts (Item 6, Plate 8) from the bearing holder

(Item 5, Plate 8). Place disc gang assemblies (Plate 8) on the proper gang frames (Item 11 and 24, Plate 1). Secure with U-bolts previously removed.

2. Position the right and left front gang assemblies (Item 24, Plate 1) so they will be in their approximate position as shown in Plate 1. Block up the assemblies so they will be in an upright position. Remove the gang bolts and bushings (Item 23, Plate 1) and attach the ends of each front gang assembly onto the brackets provided on the center frame (Item 16, Plate 1). Secure with the gang bolts and bushings previously removed.
3. Set the right and left gang assemblies (Item 11, Plate 1) in position as described above and secure to the center frame as shown in Plate 1.
4. Remove bolts in each end of the side frames (Item 8, Plate 1) and slide each end of the side frames straddle of the gang frame. After the side frames have been placed in position, close the outer ends of the gang frames as much as possible. Replace bolts.
5. Remove the bolts in the front of the center frame and insert the front cross tube (Item 22, Plate 1) as shown. Align all holes in the front cross frame with the holes in the center frame and side frames. Bolt into position but do not tighten the bolts.
6. Remove the bolt from the rear of the center frame and insert the rear cross frame (Item 13, Plate 1) into the ends of the center frames and the side frames. Bolt into position but do not tighten the bolts.
7. Remove the wheel axle bearings (Item 21, Plate 1) from the side frames and center frame. Position the wheel axle assembly (Item 9, Plate 1) under the side frames and center frame and secure in place with the wheel axle bearings and bolts provided.
8. Remove the two pins (Item 26, Plate 1) from the tongue connector brackets of the center frame and pin the tongue (Item 29, Plate 1) into position at these points with the spring rod connector bracket on top of the tongue. Pin the spring rod assembly (Item 33, Plate 1) onto the tongue. Secure the top of the spring rod assembly to the top of the center frame with the Alemite fitting on the slide (Item 30, Plate 1) up. Secure with the two shoulder bolts (Item 28, Plate 1). Install cotters in all pins.
9. Remove the pin (Item 14, Plate 1) and the depth adjustment cuff, pin and cotter (Items 17 and 18, Plate 1). Place the rear of the depth adjustment bar (Item 15, Plate 1) through the opening provided at the rear of the center frame. Connect the front of the depth adjustment bar to the bracket provided on the wheel axle and secure with the pin and cotters provided. Replace the depth adjustment cuff, pin, and cotter on the depth adjustment bar behind the opening provided on the rear of the center frame.
10. Shift the front and rear gang assemblies until the desired amount of angle is reached in each gang. Both front gang assemblies should have the same amount of angle and both rear gang assemblies should have the same amount of angle. Secure the gang assemblies in position with the $\frac{3}{4}$ " x $6\frac{1}{2}$ " bolts by placing one bolt provided in the side frames and behind the gang frames.
11. Adjust all scrapers, tighten all bolts and spread all cotters. Mount wheels in narrow position. Grease all Alemite fittings.

Wing Assembly

1. Remove the U-bolts (Item 6, Plate 8) from the bearing holder (Item 5, Plate 8). Place disc gang assemblies on the proper wing gang frames (Items 1 and 7, Plate 1) and secure with U-bolts previously removed.
2. Remove the wing connector pin (Item 3, Plate 1) from each wing gang frame (Item 1 and 7, Plate 1). Place the wing assemblies in their respective positions and pin into position with the wing connector pin.
3. Remove the U-bolts from the eye bolt connector bracket (Items 10 and 19, Plate 1) and mount them on the front and rear gang frames inside the side frames. When mounted properly the upright leg of the eye bolt connector bracket is to the inside of the harrow with the long end of the bracket to the inside. Proper mounting will prevent the wings from "wedging" when folded.
4. Place one end of the extension spring (Item 4, Plate 1) through the spring lever on the wing gang frame. Remove the outside nuts and washers from the eye bolt (Item 20, Plate 1) and insert the eye bolt into the hole provided in the eye bolt connector bracket with the eye to the outside of the harrow. Connect the loose end of the extension spring to the eye bolt and secure the